

Wm. Bingham

John Bringham

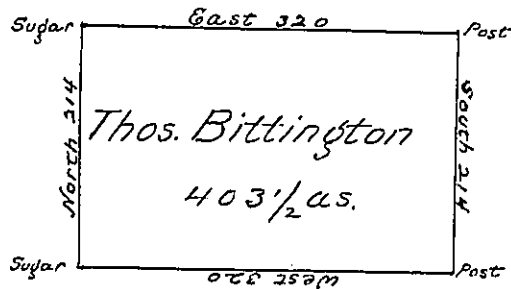

Robert Barnhill

John Bidwell

Situate on the waters of Lake Erie in
 Allegany County Surveyed on the 17th day of Sep-
 tember 1795 to Thomas Bittington on his warrant
 dated 30th. May 1792 Containing four hundred &
 three acres & an half & allowance.

Thos. Rees D.S.

Daniel Brodhead Esqr. }
 Surveyor General }

IN TESTIMONY that the above is a copy of the original remaining on file in
 the Department of Internal Affairs of Pennsylvania, made
 conformably to an Act of Assembly approved the 16th day of
 February, 1833, I have hereunto set my Hand and caused
 the Seal of said Department to be affixed at Harrisburg,
 this fourth day of June 1901

James W. Fatta
 Secretary of Internal Affairs.